

**NOTES:**

- Pedestrians will be diverted to the Western Footpath
- Access will be maintained at all times for those entering / exiting their driveway in the streets affected by the closure.

2 x signs to be installed instead of VMS boards.

**CASTLEREAGH STREET CLOSED FOLLOW DETOUR**

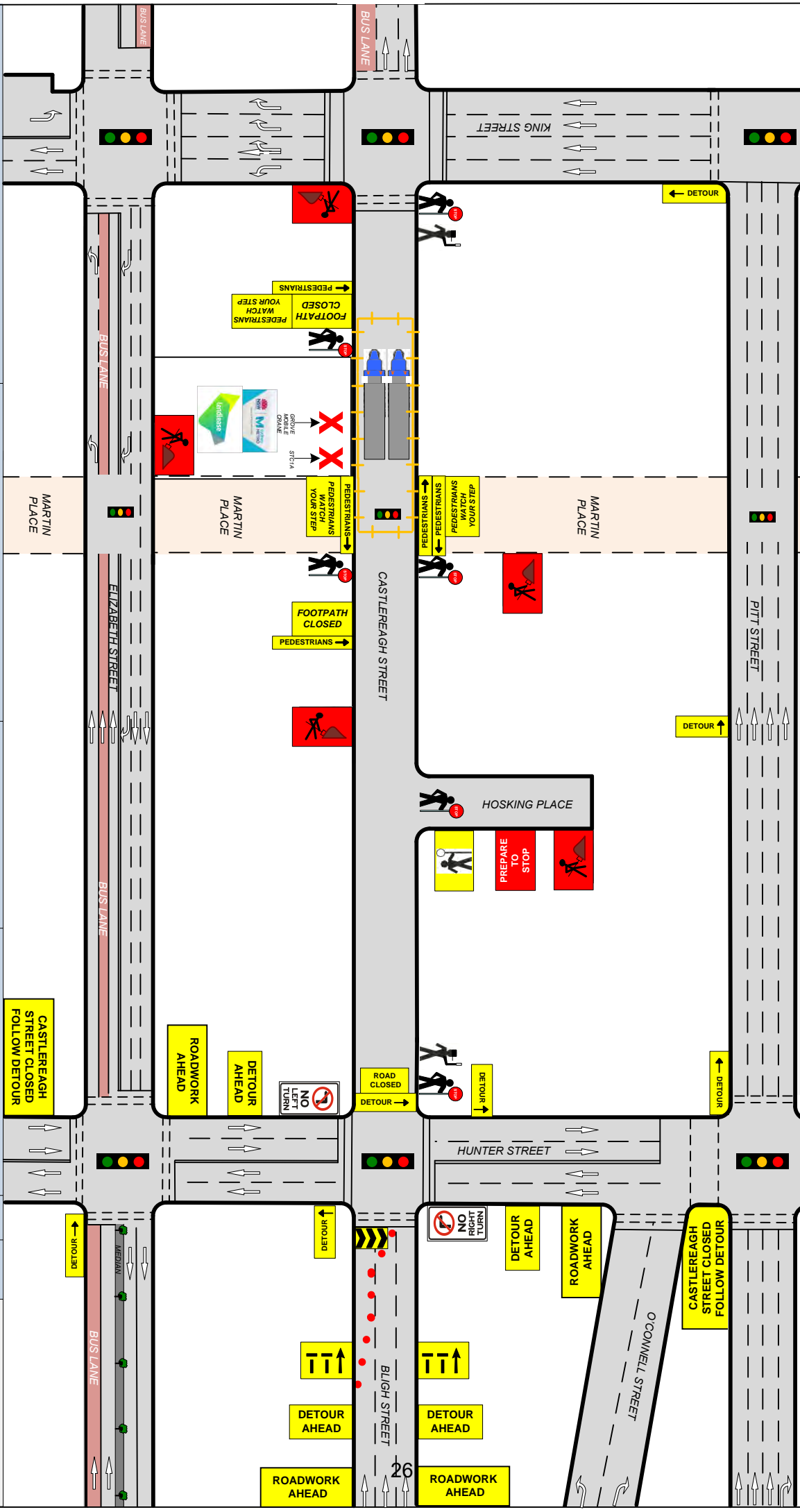
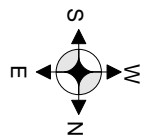

**ATM**  
**ADAMS TRAFFIC MANAGEMENT SERVICES**

12/7 Hoyle Ave, Castle Hill NSW 2154  
 Email: david@adamstraffic.com.au  
 Email: keryne@adamstraffic.com.au  
 David 0415 475 742 | Fax: 9899 3304  
 Keryne 0415 925 861 | 0402 420 164  
 Ph.: 1800 330 378  
 Website: adamstraffic.com.au

**Marr Contracting**

5010 Castlereagh Street,  
 Sydney NSW 2000

**Client:** Marr Contracting

**Location:** 5010 Castlereagh Street, Sydney NSW 2000

**Approach Speeds = up to 50KM/H**  
 Day/Night - Class 1 Signs to be used  
 All Personnel to wear HI Vis Clothing,  
 Cone Spacing 5M in Taper  
 Cone Spacing 10M in Delineation  
 Vehicles to park within the worksite  
 RMS certified Traffic Controllers to be employed

**NOTE:** This Traffic Guidance Scheme (TGS) is drawn to AS 1742.3 and the RMS worksite manual for traffic control at work sites and is to be implemented as such. This TGS can be altered on site, & must be dated & signed by an RMS accredited person, who then becomes responsible for the implementation of the changed TGS.

**NOT TO SCALE**

Drawn by: David Adams  
 RMS No: 0047594617  
 Exp Date: 16/10/2020

Signed by: *[Signature]*

UBD Ref: **F, H8**

TGS No: **8742-2**

Date: 22/4/20